

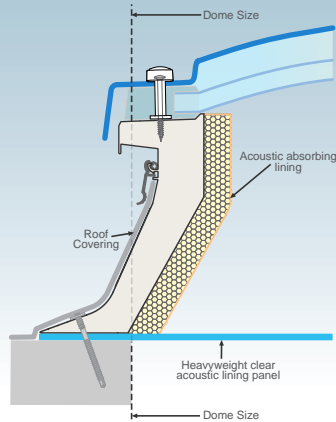

For **Acoustic Pack** on to
Mardome Ultra
See **Page 2** overleaf

Mardome Acoustic Pack



The Acoustic Pack is effective in reducing rain noise penetration (LiA) by over 15dB to 47dB.

(e.g. Standard Triple skin = 61.8dB
Standard Triple skin with Acoustic Pack = 46.7dB)

The pack consists of an acoustic absorbing liner up the inside of the sloped kerb plus a heavyweight acoustic liner beneath the kerb. The acoustic pack is supplied fully assembled.

Note:

- i. 10dB reduction equates to a drop of 50% in the sound level.
- ii. The acoustic pack is only available with Mardomes which are non-opening and non-ventilated.

Mardome Contents

i Please unpack and check that all correct parts are included and undamaged.

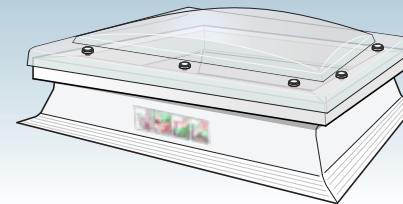

With this assembly, you will receive:
Kerb Fixing

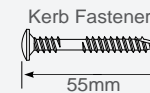

Fixing Quantities

Length of Nominal Dome Side (mm)	Number of fixings per side
600, 750	2
900, 1050, 1200	3
1350, 1500	4
1800	5
2400	7

(All fixings supplied in packs of 5.)

Installation Instructions

- a** Carefully remove rooflight from it's packaging.
- b** Mastic/Silicone around the edge of the roof opening and correctly place rooflight, ensuring it is located squarely over the roof opening.
- c** Fix sloping kerb to the roof using the 55mm kerb fastener.

See above **Fixing Quantities** table for the correct quantity of fastenings required for the size of the dome.

i N.B. Length of side refers to the nominal dome size (equivalent to inside base of kerb foot).
- d** Install roof covering up to lip, to stop under membrane clamp. Install in accordance with manufacturer's installation recommendations.

i N.B. Never apply direct heat or naked flame to the rooflight! Ensure the roof covering **does not** foul clamp!
- e** Lock the membrane clamp down fully, as shown.

Mardome Installation **⚠** Please note that all *Health and Safety Regulations* must be followed on site throughout the installation process.

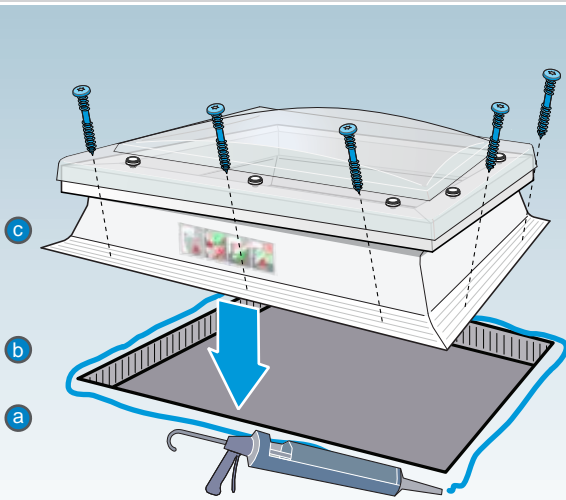

c d All Mardome Trade

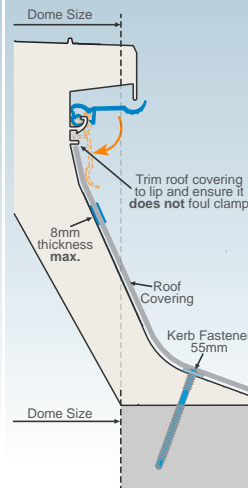

d **Roof Covering Installation**

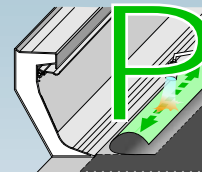

If required, lightly torch roof covering.



WARNING:
Never apply direct heat or naked flame to the roof light!

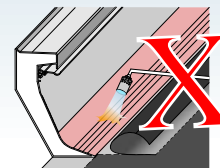

e **IMPORTANT:**
Membrane Clamp Locking



Push along line as shown to lock.
DO NOT push on soft area!

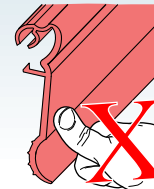

Ⓞ TECHNICAL SUPPORT: For any technical information/queries please contact your supplier.

Brett Martin Daylight Systems operates a policy of continuous product improvement, and reserves the right to alter specifications at any time without notice. Every effort has been taken to ensure all details contained in this document are correct at the time of going to press but this document should be used only as a guide and does not in any way form part of a contract or warranty. It is the customer's responsibility to ensure that the product is suitable for the actual conditions of use, which are beyond the control of Brett Martin Daylight Systems.



Mardome Acoustic Pack

Mardome Contents

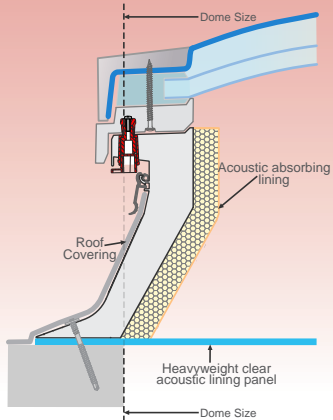

The Acoustic Pack is effective in reducing rain noise penetration (LIA) by over 15dB to 47dB.

(e.g. Standard Triple skin = 61.8dB
Standard Triple skin with Acoustic Pack = 46.7dB)

The pack consists of an acoustic absorbing liner up the inside of the sloped kerb plus a heavyweight acoustic liner beneath the kerb. The acoustic pack is supplied fully assembled.

Note:

- i. 10dB reduction equates to a drop of 50% in the sound level.
- ii. The acoustic pack is only available with Mardomes which are non-opening and non-ventilated.

i Please unpack and check that all correct parts are included and undamaged.

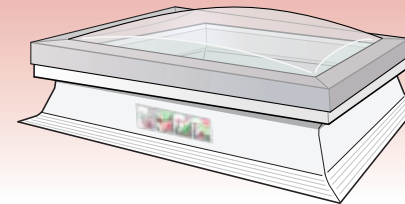

With this assembly, you will receive:
Ultra Dome Latch Key

Ultra Latch Key
x2

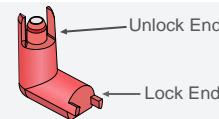

With this assembly, you will receive:
Kerb Fixing

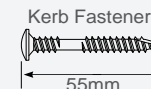

Fixing Quantities

Length of Nominal Dome Side (mm)	Number of fixings per side
600, 750	2
900, 1050, 1200	3
1350, 1500	4
1800	5
2400	7

(All fixings supplied in packs of 5.)

Installation Instructions

a Carefully remove rooflight from its packaging.

b Mastic/Silicone around the edge of the roof opening and correctly place rooflight, ensuring it is located squarely over the roof opening.

c Fix sloping kerb to the roof using the 55mm kerb fastener.

See above **Fixing Quantities** table for the correct quantity of fastenings required for the size of the dome.

i N.B. Length of side refers to the nominal dome size (equivalent to inside base of kerb foot).

d Install roof covering up to lip, to stop under membrane clamp. Install in accordance with manufacturer's installation recommendations.

i N.B. **Never** apply direct heat or naked flame to the rooflight! Ensure the roof covering **does not** foul clamp!

See diagram **d.** on page 1.

e Lock the membrane clamp down fully, as shown.

See diagram **e.** on page 1.

Mardome Installation **!** Please note that all *Health and Safety Regulations* must be followed on site throughout the installation process.

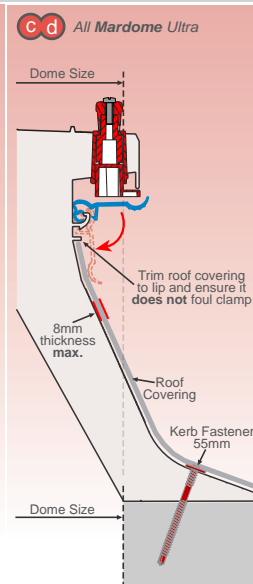
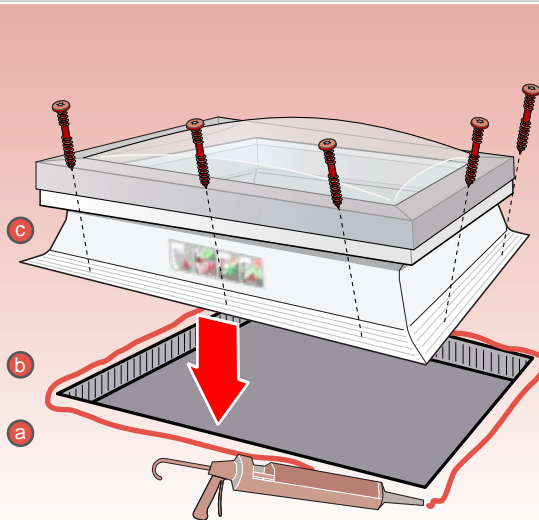

Ultra Latch Further Information
Unlocking of dome with key

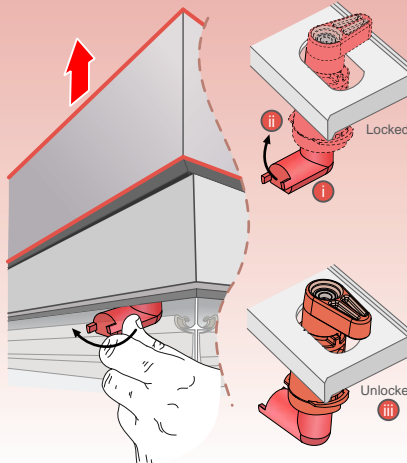

NOTE: Rotate key clockwise to **UNLOCK**.

IF dome removal is subsequently required:

i. Insert the **Unlock** end of the red Ultra Latch Key into the bottom of the latch (with the **Lock** end facing outwards) and push upwards until it clicks into place

ii. Rotate the latch ¼ turn clockwise whilst firmly pushing dome down onto kerb, until the **Lock** end is parallel to the kerb, to release. Remove key by pulling downwards.

iii. Repeat for each latch, then lift off dome assembly.

To refit the dome, insert the **Lock** end of the red Ultra Latch Key into the bottom of the latch (with the **Unlock** end facing outwards).

i. Rotate the latch ¼ turn anti-clockwise whilst firmly pushing dome down onto kerb, until the latch clicks into its **End Position**.

ii. Remove key by rotating ¼ turn clockwise.

iii. Repeat for each latch.

TECHNICAL SUPPORT: For any technical information/queries please contact your supplier.